

**SECTION A-A**  
**51" SINGLE SLOPE**  
**CONCRETE BARRIER WALL**

**32" JERSEY SHAPE**  
**CONCRETE BARRIER WALL**

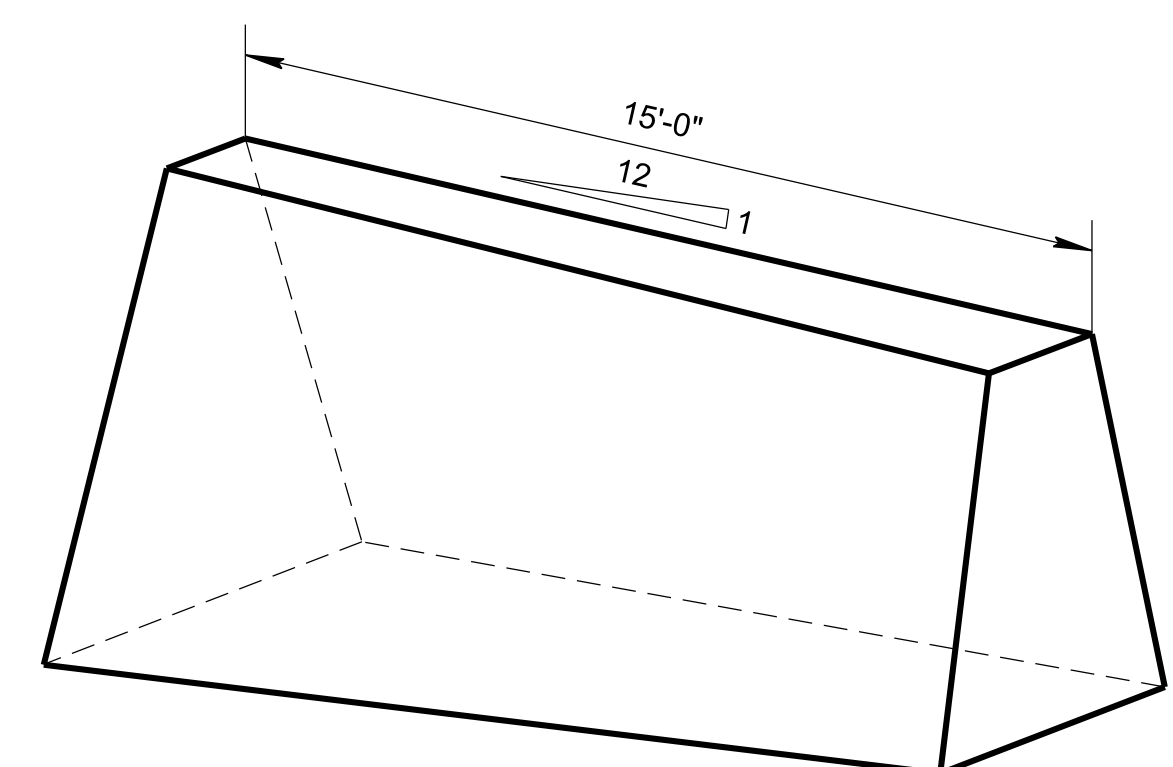
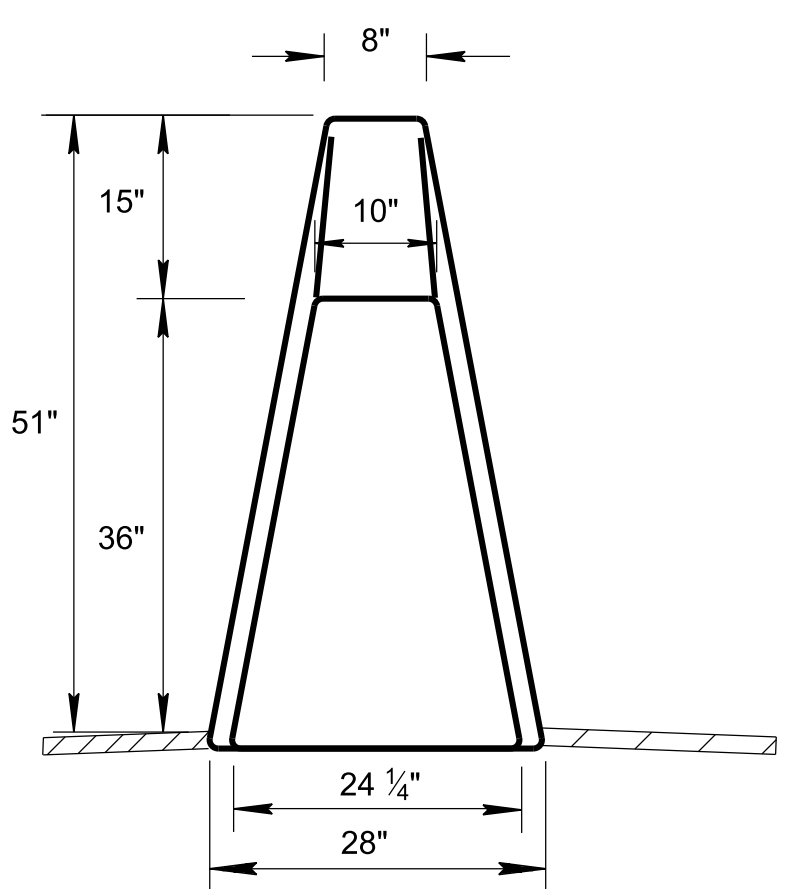
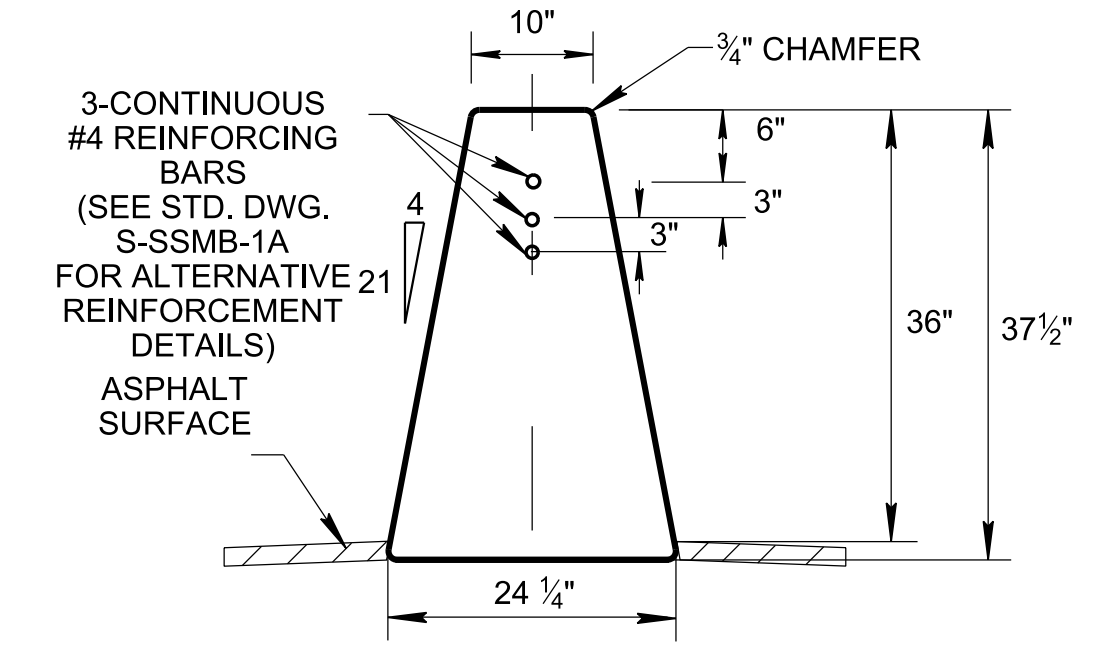
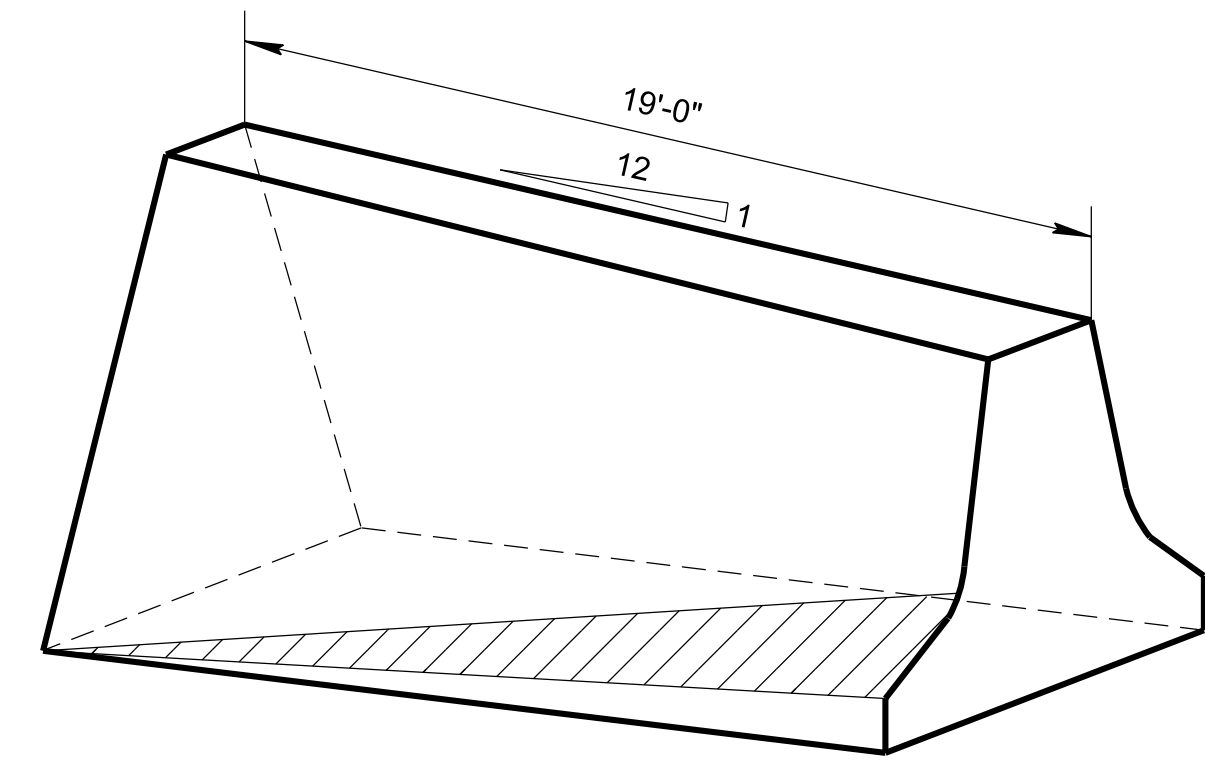
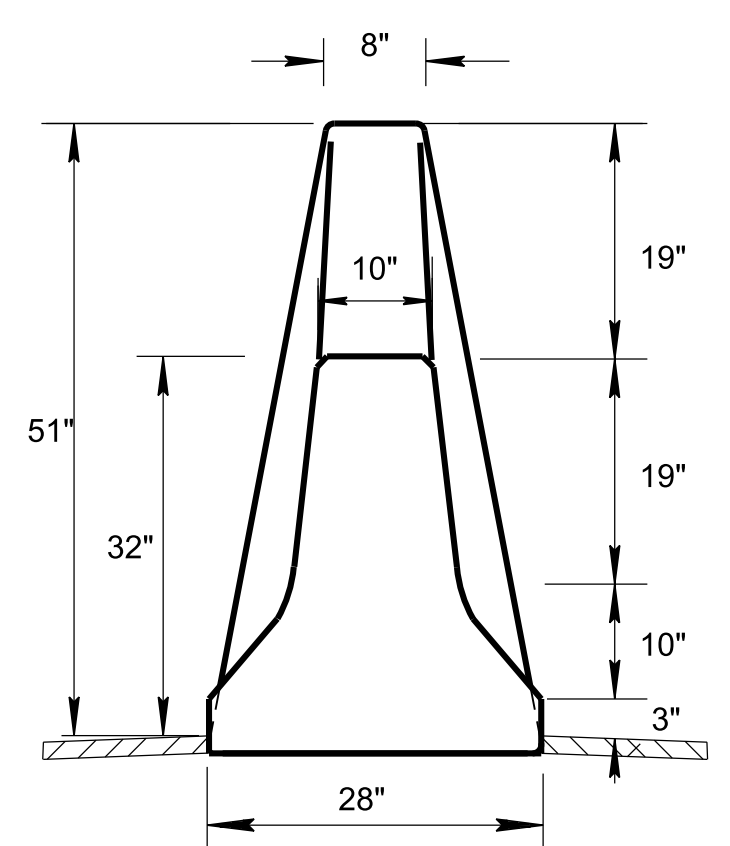
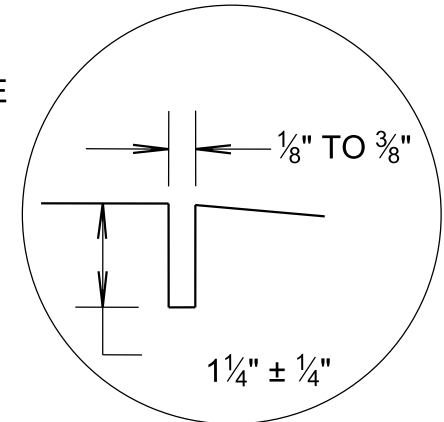

GENERAL NOTES	
(A)	CONCRETE BARRIER WALL SHALL BE CONSTRUCTED IN ACCORDANCE WITH STANDARD SPECIFICATIONS FOR ROAD AND BRIDGE CONSTRUCTION, SECTION 711 AND/OR CURRENT SPECIAL PROVISIONS.
(B)	CONCRETE: $F_c = 3,000$ POUNDS PER SQUARE INCH AT 28 DAYS REINFORCING STEEL: ASTM A615, $F_y = 60,000$ POUNDS PER SQUARE INCH ALL REINFORCING IS TO BE INSTALLED AS DETAILED ON THIS DRAWING.
(C)	REFER TO STANDARD DRAWINGS S-SSMB-1 AND S-SSMB-2 FOR ADDITIONAL INFORMATION.
(D)	CONTRACTION JOINT TO BE PLACED AT THE BEGINNING AND ENDING OF THE TRANSITION.
(E)	CHAMFER TOP AND END EDGES 3/4 INCH.
(F)	PAYMENT FOR MEDIAN BARRIER TRANSITION WILL BE INCLUDED IN THE UNIT PRICE OF 51IN SINGLE SLOPE CONCRETE BARRIER WALL.

STATE OF TENNESSEE  
 STANDARD DRAWING  
 DEPARTMENT OF TRANSPORTATION

**SPECIAL DETAIL**  
**FOR CONCRETE**  
**MEDIAN BARRIER**  
**WALL TRANSITION**  
 (FROM 32" OR 36" TO 51")

03-15-2023 S-SSMB-10

1/9/2024 9:31:49 AM  
 P:\StandDraw\DESIGN STANDARDS\Standards Drawings\Standard Roadway Drawings - CURRENT\In Progress\10-107.00 Safety Design and Guardrails IP\107.09 Concrete Median Barriers IP\SSMB10-2-

NOT TO SCALE