

PIPESKEW	TYPICAL BARS FOR 4:1 SLOPE, CONCRETE PIPE ROUND INLET OR SIDE TAPERED INLET																		TYPICAL BARS FOR 4:1 SLOPE, CONCRETE PIPE ROUND INLET ONLY										TYPICAL BARS FOR 4:1 SLOPE, CONCRETE PIPE SIDE TAPERED INLET ONLY																																		
	BARS F		BARS FB		BARS FC		BARS WXL		BARS WXS		SERIES BARS WYL (2 REQ'D)				SERIES BARS WYS (2 REQ'D)				2 BARS WZL		2 BARS WZS		SERIES BARS WL (1 REQ'D)				SERIES BARS WS (1 REQ'D)				SERIES BARS WLA (1 REQ'D)				SERIES BARS WSA (1 REQ'D)				SERIES BARS FA (1 REQ'D)				BARS FD		4 BARS W		2 BARS T		SERIES BARS FA (1 REQ'D)				BARS FD		4 BARS W		2 BARS TA						
T.L.	N.R.	T.L.	N.R.	T.L.	N.R.	T.L.	N.R.	T.L.	N.R.	A	B	C	X	T.L.	A	B	C	X	T.L.	A	B	C	X	T.L.	A	B	C	X	T.L.	A	B	C	X	T.L.	A	B	C	X	T.L.	T.L.	N.R.	A	B	C	X	T.L.	T.L.	N.R.	A	B	C	X	T.L.										
15°	45°	6'5"	4	3'3"	4	2'5"	11	6'6"	4	3'4"	4	3'2"	3'2"	0"	1	3'2"	19"	19"	0"	1	19"	8'2"	5'0"	2'4"	17"	1 1/2"	7	18'5"	2'4"	17"	3"	4	10'6"	2'4"	17"	1 1/2"	7	13'9"	2'4"	17"	3"	4	7'10"	6'9"	4'3"	10"	4	2'20"	3'9"	4	5'9"	8'1"	7'5"	4'11"	10"	4	2'48"	3'9"	5	6'6"	2'4 1/2"	19"	8'1"

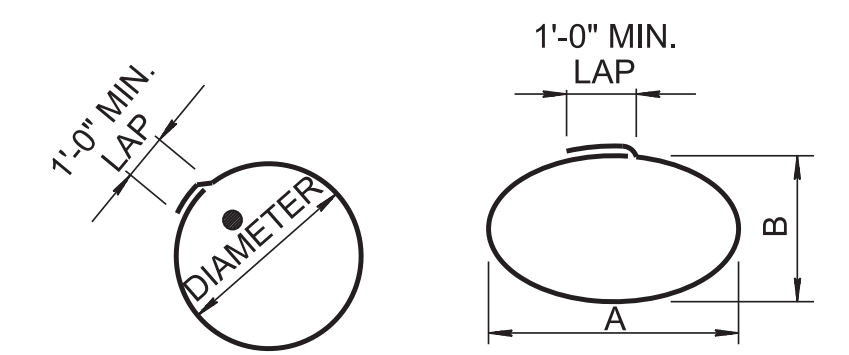

★ BARS "T" (SIZE NO. 4)
★ BARS "TA" (SIZE NO. 4)

VARIABLES IN LENGTH FROM DIM. "A" TO DIM. "B" IN INC. OF DIM. "C" X = NO. OF BARS REQD.



★ SERIES BARS "WL" OR "WS" (SIZE NO. 4)



★ BARS "F", "FB", "FC", "WXL", "WXS", "WZL", "WZS", "W" (SIZE NO. 4)

VARIABLES IN LENGTH FROM DIM. "A" TO DIM. "B" IN INC. OF DIM. "C" X = NO. OF BARS REQD.

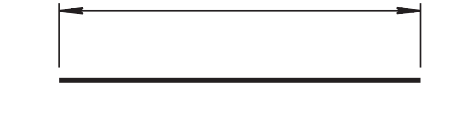

★ SERIES BARS "WYL", "WYS", "WLA", "WSA" (SIZE NO. 4)



★ SERIES BARS "FA" TOTAL LENGTH VARIES FROM DIM. "A" TO DIM. "B" IN INCREMENTS OF DIM. "C" (BEND IN FIELD AS REQUIRED) (SIZE NO. 6)



★ BARS "FD" (SIZE NO. 6)

MINOR REVISION -- FHWA APPROVAL NOT REQUIRED

STATE OF TENNESSEE STANDARD DRAWING DEPARTMENT OF TRANSPORTATION

TYPE "B" CONCRETE ENDWALLS, BILL OF STEEL FOR CONCRETE PIPES (PIPE SIZES 15" TO 78", ALL SKEWS, 4:1 SLOPE)

TYPE	SIZE	SERIES
A	5	06

★ NOTE: FOR TOTAL LENGTH SEE BILL OF STEEL ABOVE.
● DIAMETER= [STEEL PIPE SIZE + 6" CONCRETE PIPE SIZE + 12"]

NOTE: DIMENSIONS SHOWN ON THIS SHEET ARE OUTSIDE TO OUTSIDE OF BAR. STANDARD C.R.S.I. HOOK DETAILS SHALL APPLY, EXCEPT AS NOTED.
NOTE: N.R. OR X = NO. REQUIRED. T.L. = TOTAL LENGTH