

MAP RECORD	
FIELD DATA OBTAINED IN 1994	
FIELD EXAMINATION MADE IN 1997	
REVISIONS	DATE

LEGEND

- SCHOOL
- CHURCH
- CHURCH WITH CEMETERY
- CEMETERY
- HOSPITAL
- POST OFFICE
- HIGHWAY PATROL STATION
- CITY HALL OR COMMUNITY CENTER
- MONUMENT
- AIRPORT - COMPLETE FACILITIES
- AIRPORT - LIMITED FACILITIES
- LANDING AREA OR STRIP
- POWER PLANT
- WEIGHT STATION
- HIGHWAY GARAGE (S-STATE, C-COUNTY)
- TRIANGULATION STATION
- OBSERVATION OR LOOKOUT TOWER
- COUNTY SEAT
- OTHER CITIES AND VILLAGES
- RADIO OR TELEVISION STATION
- POINT OF INTEREST
- DOT TO INDICATE LOCATION OF ANY CULTURAL FEATURE OUT OF PLACE
- U S NUMBERED HIGHWAY MARKER
- STATE HIGHWAY MARKER
- FEDERAL AID PRIMARY SYSTEM
- STATE HIGHWAY MARKER
- FEDERAL AID SECONDARY SYSTEM
- PROMINENT PEAK WITH ELEVATION
- 2578
- LAKE WITH DAM
- RESERVOIR - POND OR LAKE
- LEVEE OR DYKE
- DRAINAGE CANAL
- NARROW STREAM
- WIDE STREAM
- DAM WITH LOCK
- HEAD OF NAVIGATION
- NAVIGABLE STREAM
- GRADE CROSSING
- UNDERPASS-ROAD BELOW
- OVERPASS-ROAD ABOVE
- RAILROAD TUNNEL
- GRADE SEPARATION
- FORD
- LOW WATER BRIDGE
- FREE FERRY OR TOLL FERRY
- HIGHWAY BRIDGE-OVER 20 FEET
- HIGHWAY BRIDGE-LONG RIVER CROSSING (C-CONCRETE, S-STEEL, W-WOOD)
- PRIMITIVE OR UNIMPROVED ROAD
- GRADED AND DRAINED, SOIL, GRAVEL OR STONE SURFACED ROAD
- PAVED ROAD
- PAVED HIGHWAY OR ROAD
- DIVIDED ROADWAY
- DISTANCE IN MILES BETWEEN DESIGNATED POINTS
- FULL CONTROL OF ACCESS
- NPS NATIONAL PARK SERVICE HIGHWAY
- HIGHWAY INTERCHANGE
- COUNTY LINE
- STATE LINE
- MONUMENTED BOUNDARY MARKER
- INCORPORATED CITY BOUNDARY
- RESERVATION BOUNDARY
- PAVED OR GRAVEL PUBLIC ROAD
- MAINTENANCE NOT CITY OR COUNTY RESPONSIBILITY

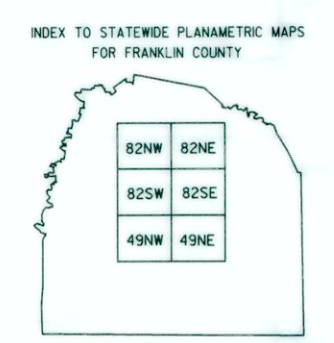

FEDERAL AID SECONDARY ROUTES SHOWN IN RED ARE BASED ON SYSTEM ROUTE INFORMATION CIRCA 1976, THE YEAR THE PROGRAM ENDED.

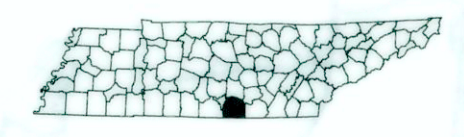

GENERAL HIGHWAY MAP
FRANKLIN COUNTY
 TENNESSEE

PREPARED BY THE
 TENNESSEE DEPARTMENT OF TRANSPORTATION
 BUREAU OF PLANNING AND DEVELOPMENT
 PLANNING DIVISION
 IN COOPERATION WITH THE
 U.S. DEPARTMENT OF TRANSPORTATION
 FEDERAL HIGHWAY ADMINISTRATION



1997

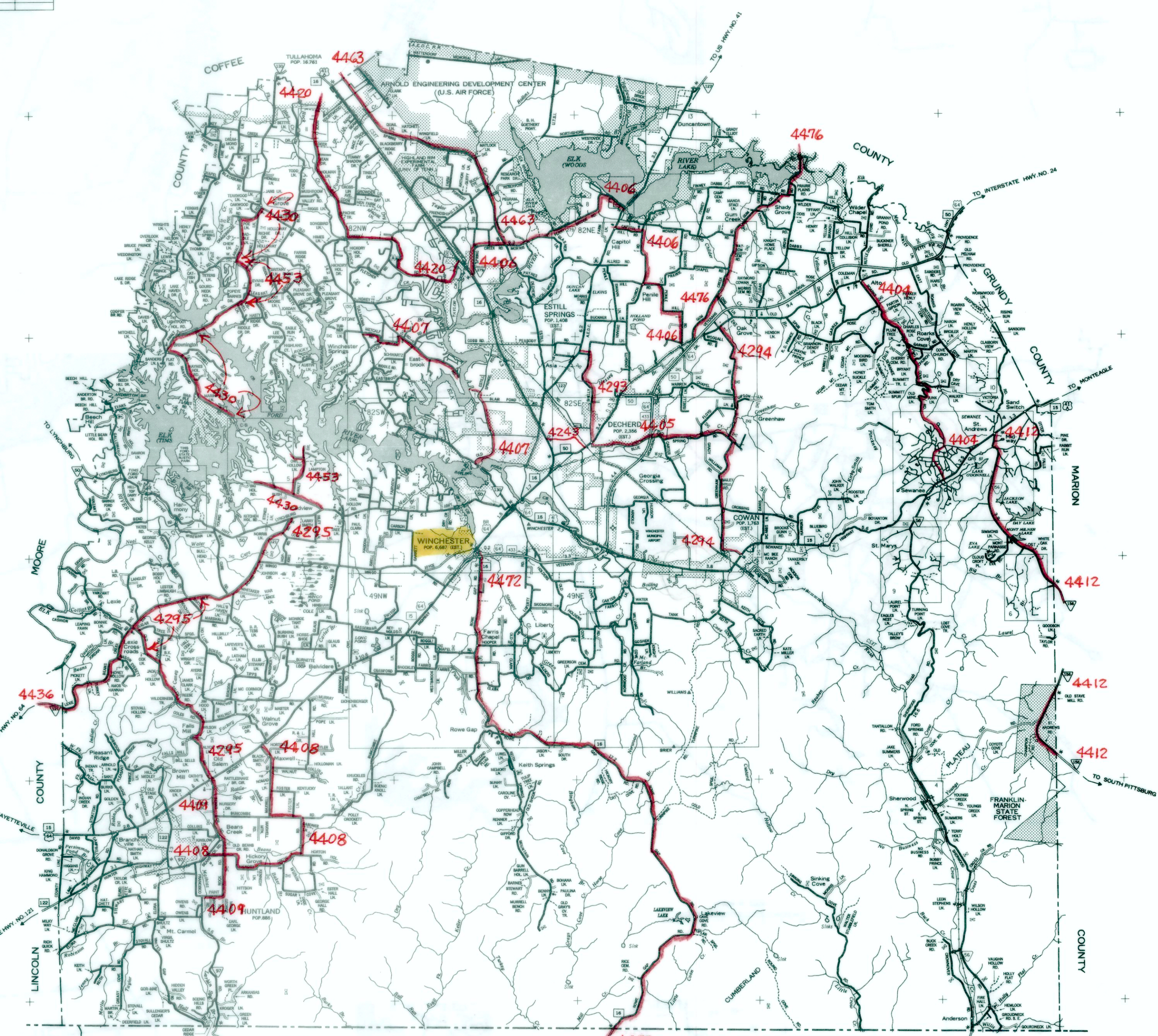

1 COUNTY MAP SHEET WITH
 2 SUPPLEMENTAL COUNTY MAP SHEET WITH
 3 STATEWIDE PLANIMETRIC MAP SHEETS AND
 4 SUPPLEMENTAL CITY MAP SHEETS
 ESTILL SPRINGS
 HUNTLAND
 TULLAHOMA

POPULATION OF FRANKLIN COUNTY
 34,725 (1990 CENSUS)

LAMBERT CONFORMAL CONIC PROJECTION
 20,000 FOOT GRID TICKS BASED ON THE
 TENNESSEE COORDINATE SYSTEM
 1927 NORTH AMERICAN DATUM



HARMONY

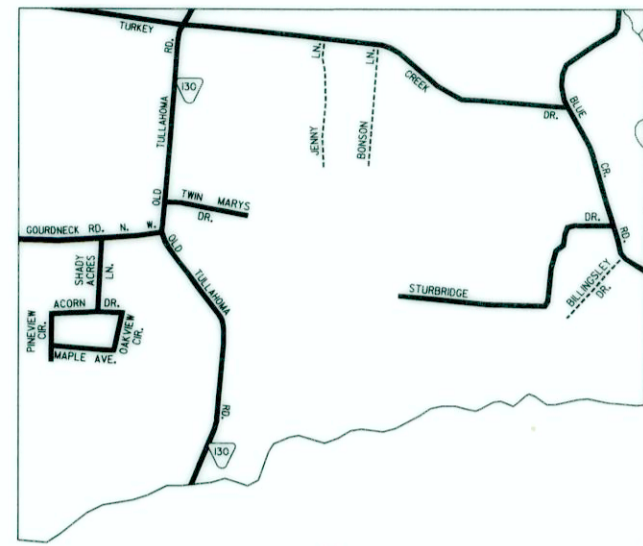

2
AREA NORTH OF CENTER GROVE

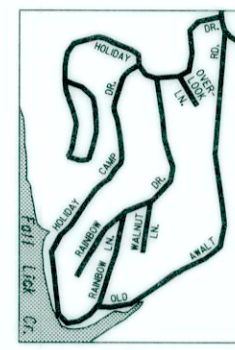

3
AREA S.W. OF CENTER GROVE

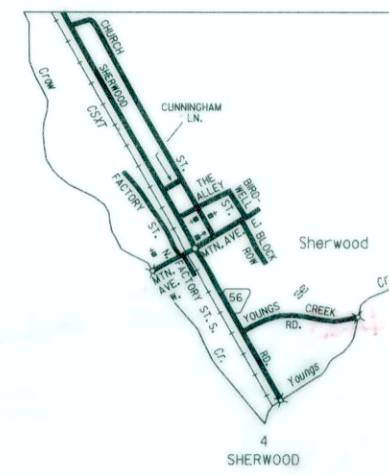

4
SHERWOOD



5
AREA N.W. OF BROADVIEW

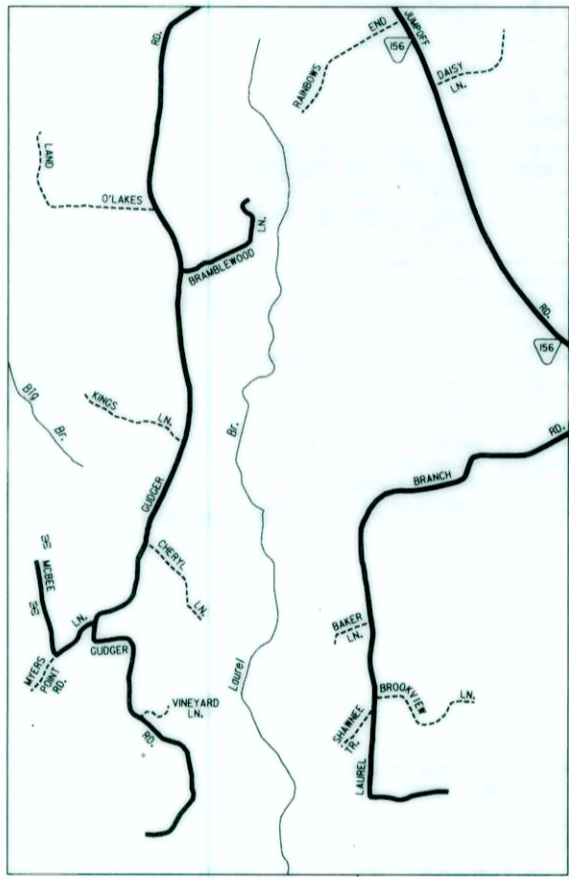

6
AREA S.E. OF SEWANEE

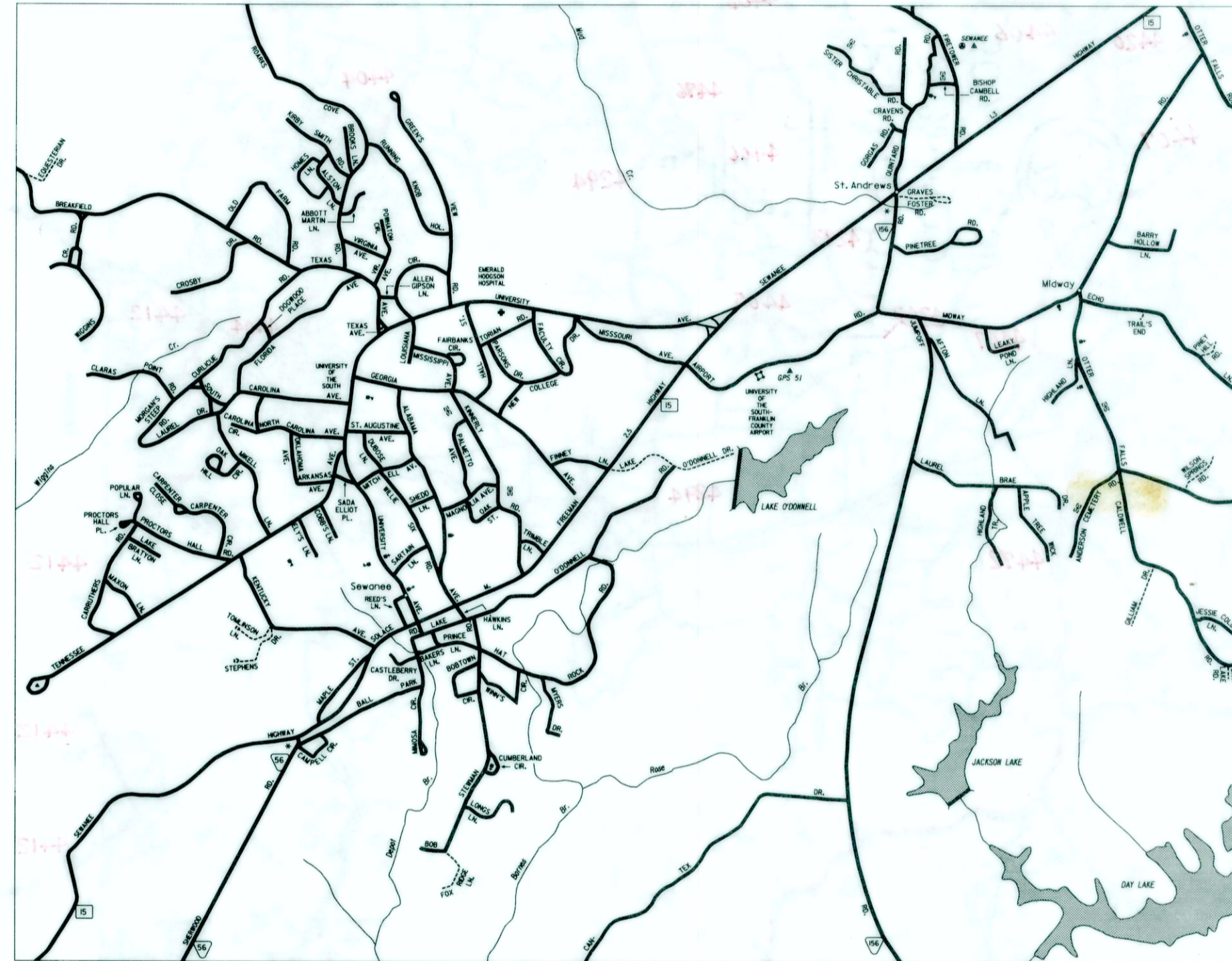

7
SEWANEE

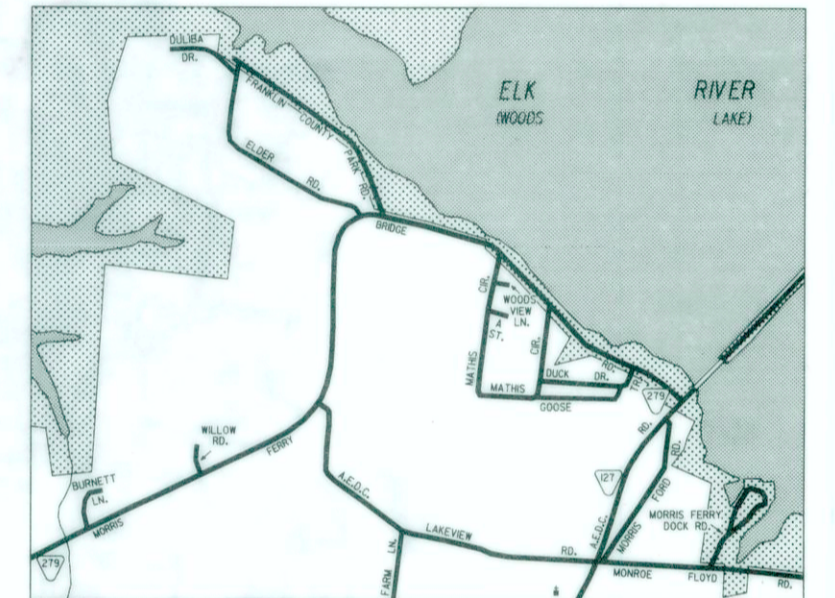

8
AREA NORTH OF CAPITOL HILL

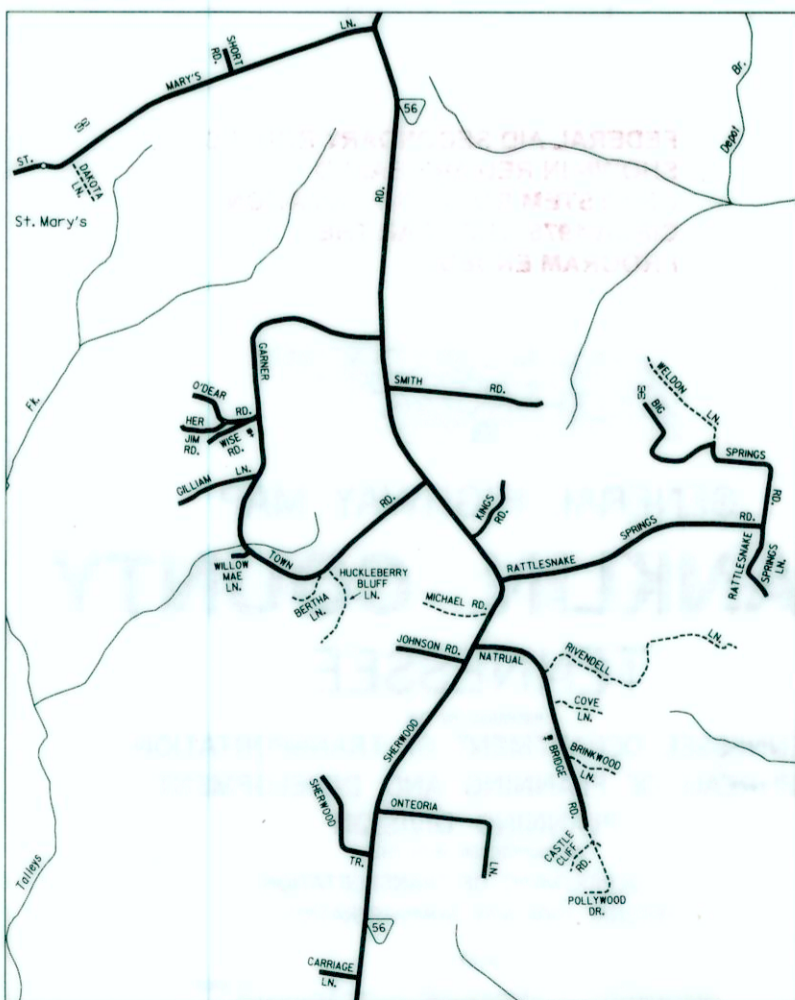

9
ST. MARY'S

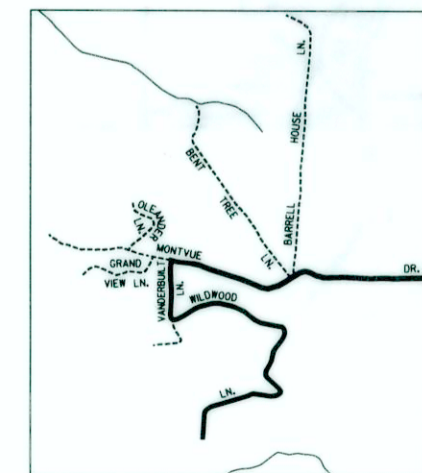

10
AREA NORTH OF SEWANEE

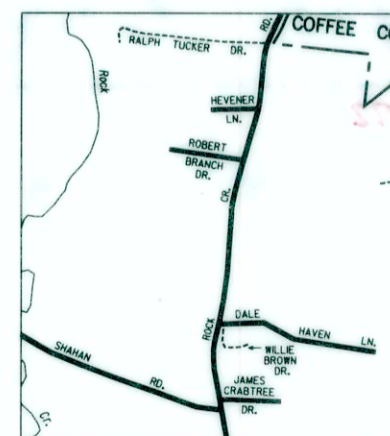
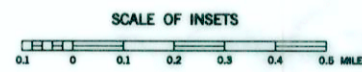

11
AREA SOUTH OF TULLAHOMA

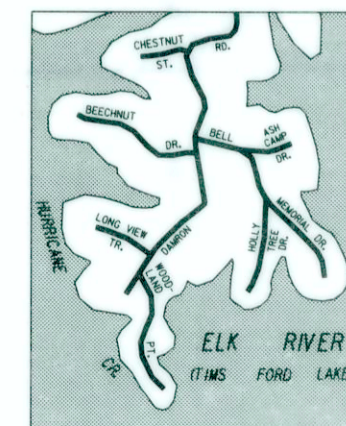

12
AREA S.E. OF BROWNINGTON

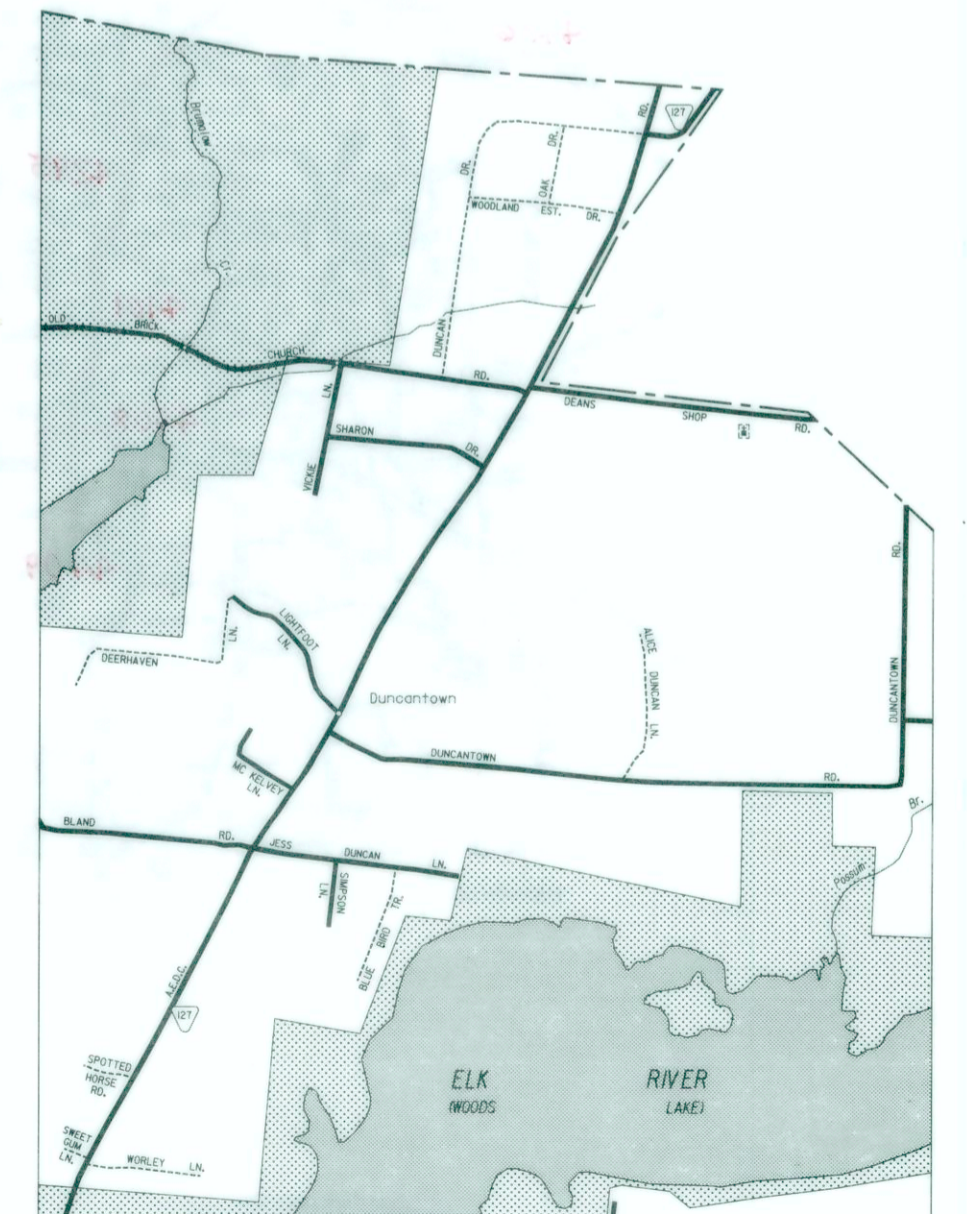

13
DUNCANTOWN