

REVISIONS	
FEATURE	DATE

LEGEND

- SCHOOL
- HOSPITAL
- POST OFFICE
- COURTHOUSE
- CITY HALL OR COMMUNITY CENTER
- MONUMENT
- AIRPORT, COMPLETE FACILITIES
- AIRPORT, LIMITED FACILITIES
- LANDING AREA OR STRIP
- OBSERVATION OR LOOKOUT TOWER
- ARMORY
- HIGHWAY GARAGE (S-STATE, C-COUNTY)
- POINTS OF INTEREST
- INTERSTATE HIGHWAY
- U.S. NUMBERED HIGHWAY
- STATE HIGHWAY
- STATE HIGHWAY
- LAKE WITH DAM
- RESERVOIR, POND OR LAKE
- LEVEE OR DYKE
- NARROW STREAM
- WIDE STREAM
- DAM WITH LOCK
- HEAD OF NAVIGATION
- NAVIGABLE STREAM
- GRADE CROSSING
- UNDERPASS-ROAD BELOW
- OVERHEAD-ROAD ABOVE
- RAILROAD TUNNEL
- GRADE SEPARATION
- FORD
- LOW WATER BRIDGE
- FREE FERRY OR TOLL FERRY
- HIGHWAY BRIDGE-OVER 20 FEET
- HIGHWAY BRIDGE-LONG RIVER CROSSING
- PRIMITIVE OR UNIMPROVED ROAD
- GRADED AND DRAINED, SOIL, GRAVEL OR STONE SURFACED ROAD
- PAVED ROAD
- GRADED AND DRAINED, SOIL, GRAVEL OR STONE SURFACED HIGHWAY
- PAVED HIGHWAY
- DIVIDED ROADWAY
- DISTANCE IN MILES BETWEEN DESIGNATED POINTS (FCA)
- FULL CONTROL OF ACCESS (NPS)
- NATIONAL PARK SERVICE HIGHWAY
- COUNTY LINE
- STATE LINE
- INCORPORATED CITY BOUNDARY
- RESERVATION BOUNDARY

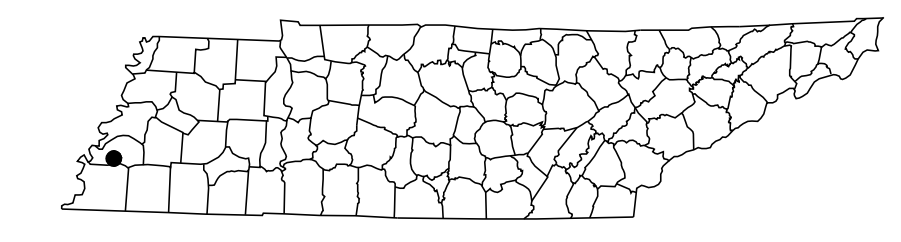
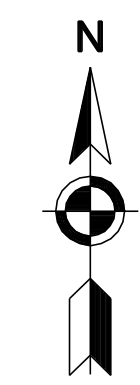

CITY MAP
ATOKA
 TIPTON COUNTY
 TENNESSEE

PREPARED BY THE
TENNESSEE DEPARTMENT OF TRANSPORTATION
 LONG RANGE PLANNING DIVISION
 IN COOPERATION WITH THE
 U.S. DEPARTMENT OF TRANSPORTATION
 FEDERAL HIGHWAY ADMINISTRATION

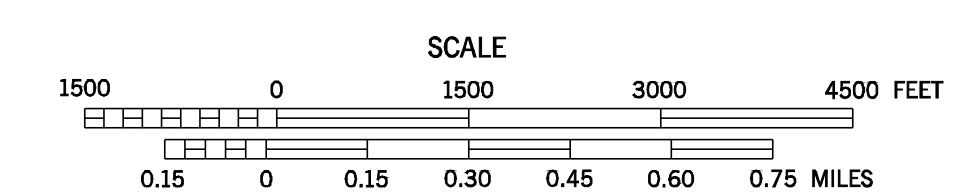

1995

AUTHORIZATION NO. 401901958402

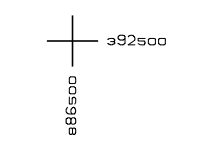
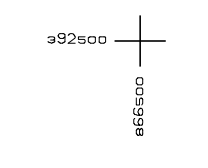
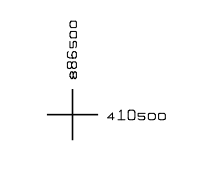
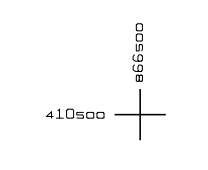
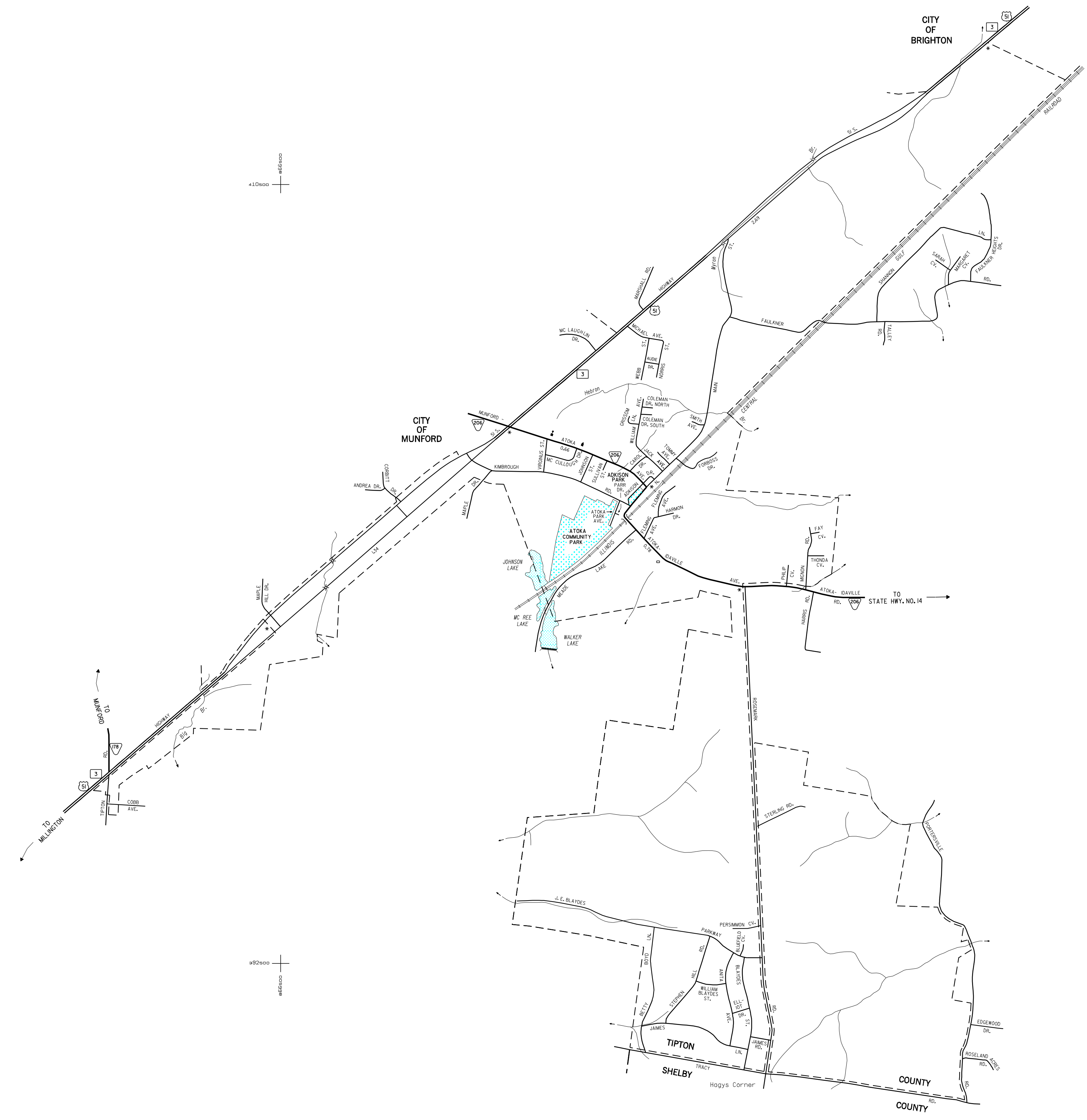

GRID TICKS BASED ON THE
 TENNESSEE COORDINATE SYSTEM
 (1927 NORTH AMERICAN DATUM)

POPULATION 659 (1990 CENSUS)