

**TENNESSEE DEPARTMENT OF TRANSPORTATION  
STRATEGIC TRANSPORTATION INVESTMENTS DIVISION**

PROJECT NO.: 60100-1209-04 ROUTE: SATURN PKWY. EXTENSION  
 COUNTY: MAURY CITY: SPRING HILL  
 PROJECT PIN NUMBER: 123399.00  
 PROJECT DESCRIPTION: SATURN PKWY. EXTENSION INTO G.M. AND S.R. 247.  
 \_\_\_\_\_  
 \_\_\_\_\_  
 \_\_\_\_\_

**DIVISION REQUESTING:**

MAINTENANCE  PAVEMENT DESIGN   
 S.T.I.D.  STRUCTURES   
 PROG. DEVELOPMENT & ADM.  SURVEY & ROADWAY DESIGN   
 PUBLIC TRANS. & AERO.  TRAFFIC SIGNAL DESIGN   
 OTHER \_\_\_\_\_   
 YEAR PROJECT PROGRAMMED FOR CONSTRUCTION: \_\_\_\_\_  
 PROJECTED LETTING DATE: \_\_\_\_\_

**TRAFFIC ASSIGNMENT:**

| BASE YEAR |      | ( SEE ATTACHMENT ) |     |   |      |           | DESIGN ROADWAY % TRUCKS |      | DESIGN AVERAGE DAILY LOADS |       |
|-----------|------|--------------------|-----|---|------|-----------|-------------------------|------|----------------------------|-------|
| AADT      | YEAR | AADT               | DHV | % | YEAR | DIR.DIST. | DHV                     | AADT | FLEX                       | RIGID |
|           | 2017 |                    |     |   | 2037 |           |                         |      |                            |       |
|           |      |                    |     |   |      |           |                         |      |                            |       |
|           |      |                    |     |   |      |           |                         |      |                            |       |
|           |      |                    |     |   |      |           |                         |      |                            |       |

REQUESTED BY: NAME AMY RAUCH DATE 7/27/16  
 DIVISION S.T.I.D.  
 ADDRESS 1000 J.K. POLK BLDG.  
NASHVILLE, TN. 37243

REVIEWED BY: TONY ARMSTRONG Tony Armstrong DATE 9-13-16  
 TRANSPORTATION MANAGER 1  
 SUITE 1000, JAMES K. POLK BUILDING

APPROVED BY: MIKE PRESLEY Mike Presley DATE 9-13-16  
 TRANSPORTATION MANAGER 2  
 SUITE 1000, JAMES K. POLK BUILDING

**COMMENTS:**

THIS TRAFFIC IS BASED ON 2015 CYCLE COUNTS, 2-12 HOUR TURNING MOVEMENT COUNTS (AUG. 2016) AND 4-24 HOUR MACHINE COUNTS (AUG. 2016). THE DESIGN YEAR TRAFFIC IS BASED ON THE GROWTH RATE FOR S.R. 396 FROM THE NASHVILLE MPO COMPUTER ASSIGNMENT MODEL PLUS TRIP GENERATION FOR 1048 ADDITIONAL EMPLOYEES.

**DHV'S ARE NOT REQUIRED FOR SIDE ROADS LESS THAN 1000 AADT.**

NOTE: FOR BRIDGE REPLACEMENT PROJECTS, ADLs ARE NOT REQUIRED FOR ADTs OF 1000 OR LESS AND PERCENTAGE OF TRUCKS OF 7% OR LESS.  
 SEE ATTACHMENTS FOR TURNING MOVEMENTS AND/OR OTHER DETAILS.



Figure 9: Final Design



**AADT**

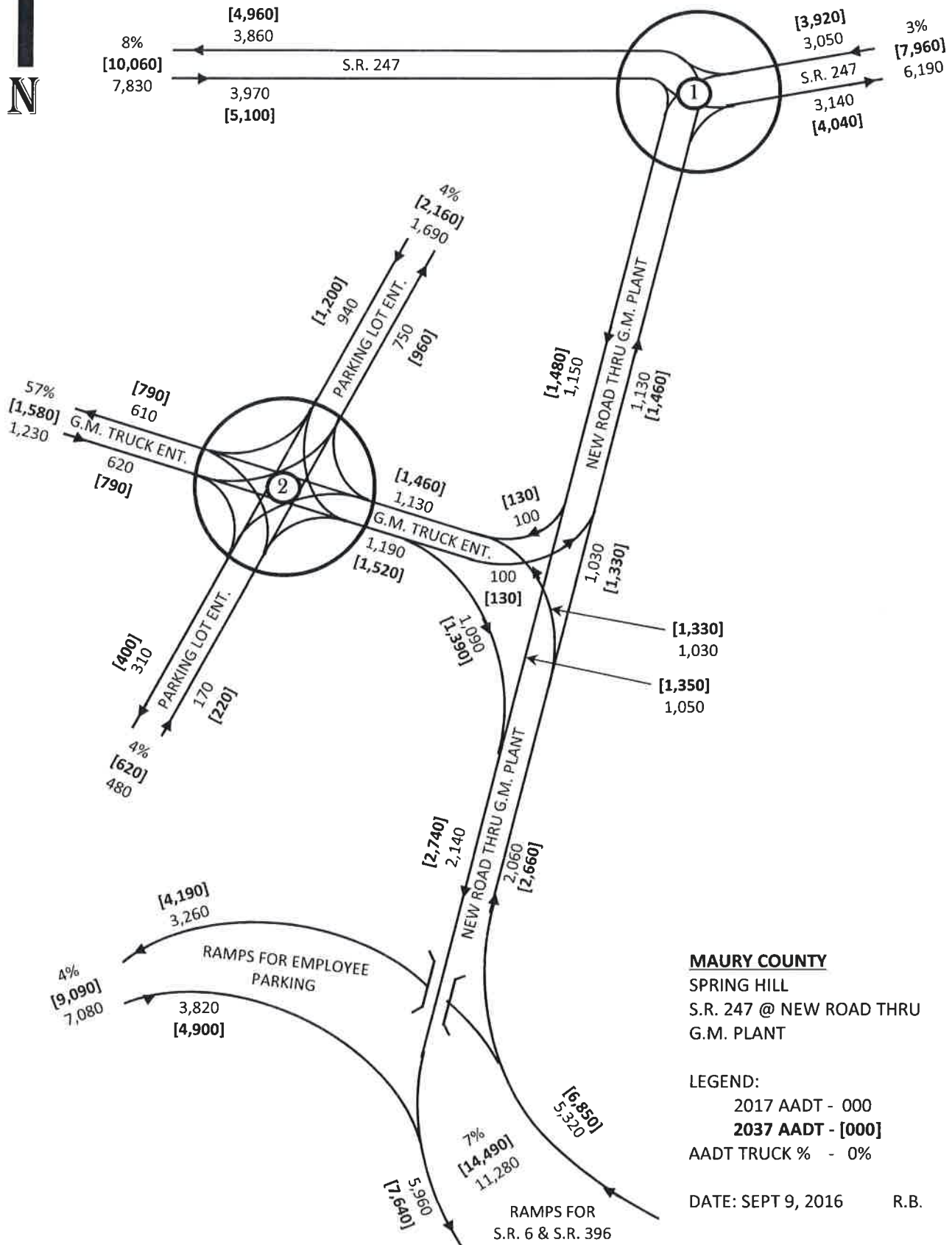

**MAURY COUNTY**  
SPRING HILL  
S.R. 247 @ NEW ROAD THRU  
G.M. PLANT

LEGEND:  
2017 AADT - 000  
2037 AADT - [000]  
AADT TRUCK % - 0%

DATE: SEPT 9, 2016 R.B.



**AADT**

1

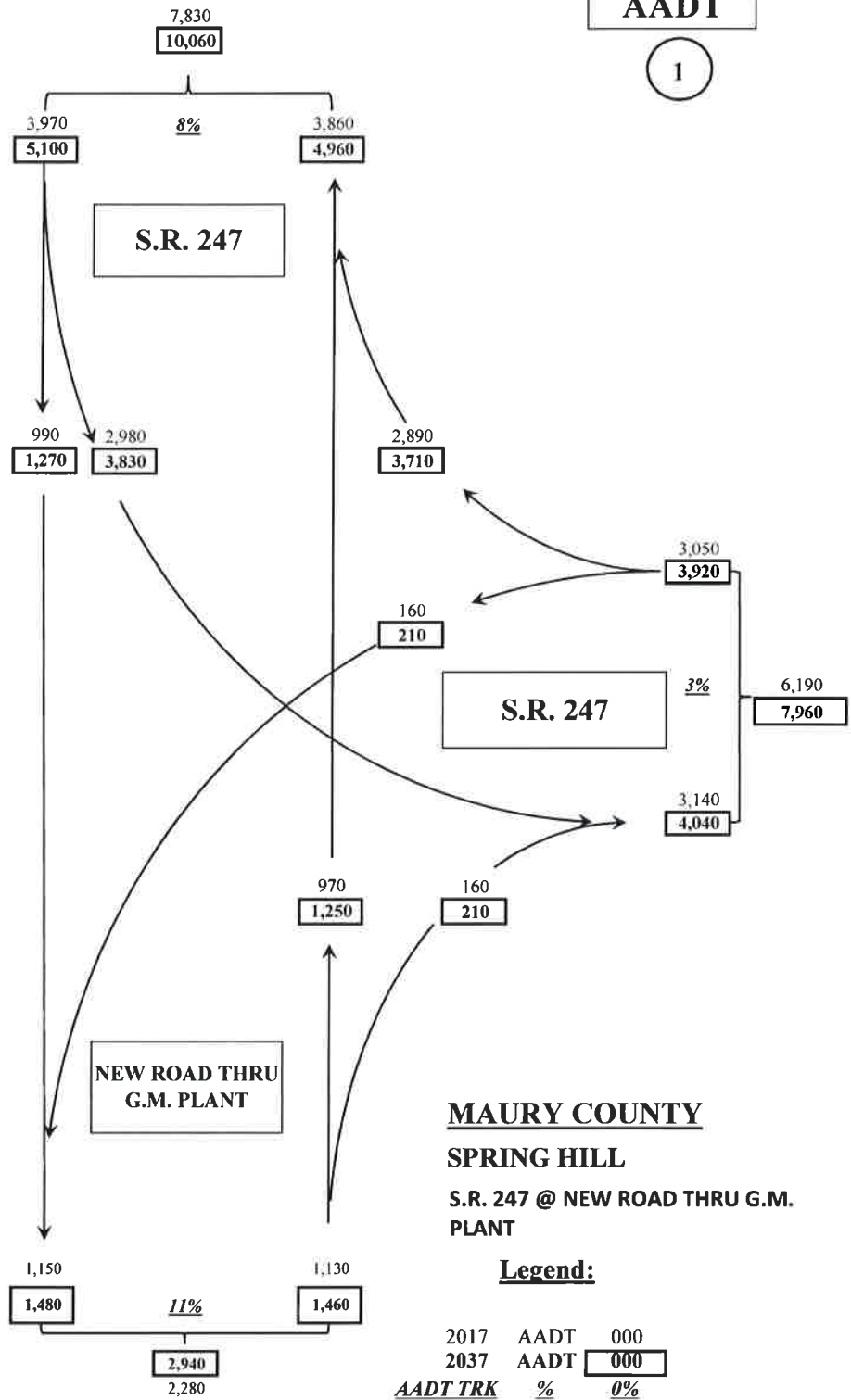

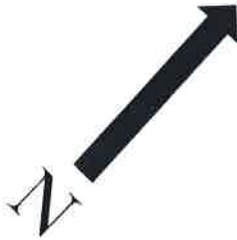

**AADT**

2

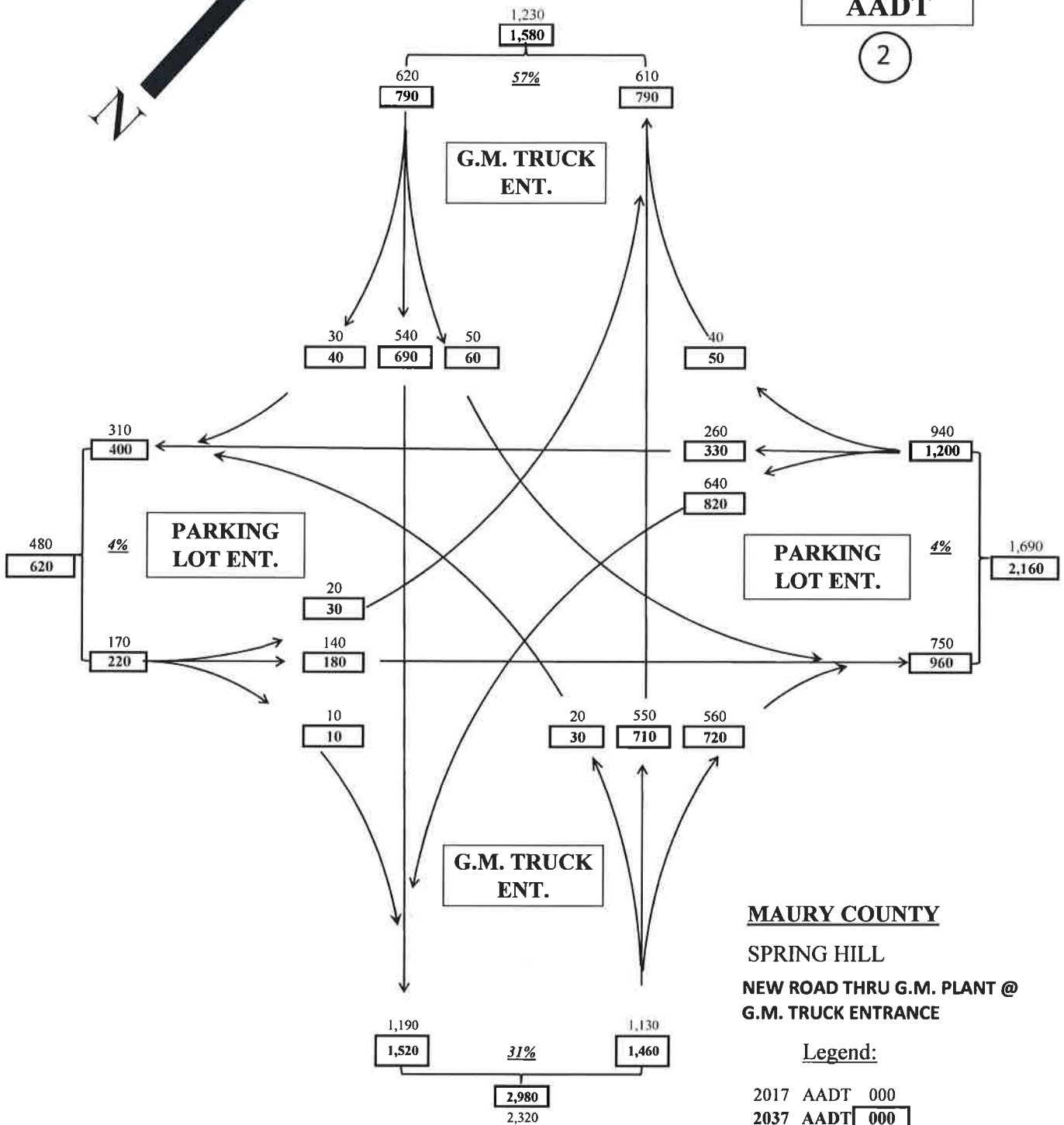

9/9/2016

R.L.B.

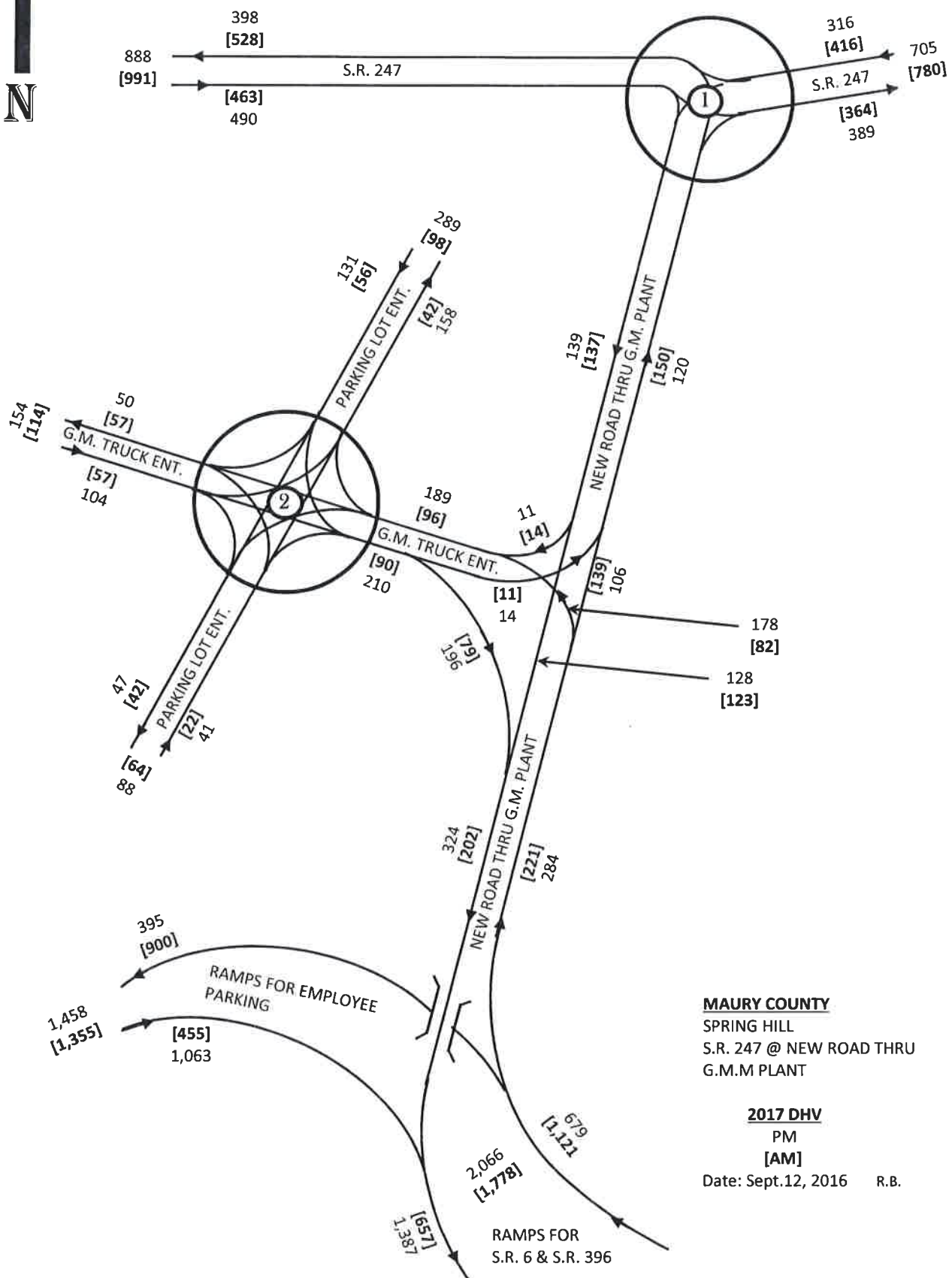

**MAURY COUNTY**  
 SPRING HILL  
 S.R. 247 @ NEW ROAD THRU  
 G.M.M PLANT

**2017 DHV**  
 PM  
**[AM]**  
 Date: Sept.12, 2016 R.B.

2017 DHV

1

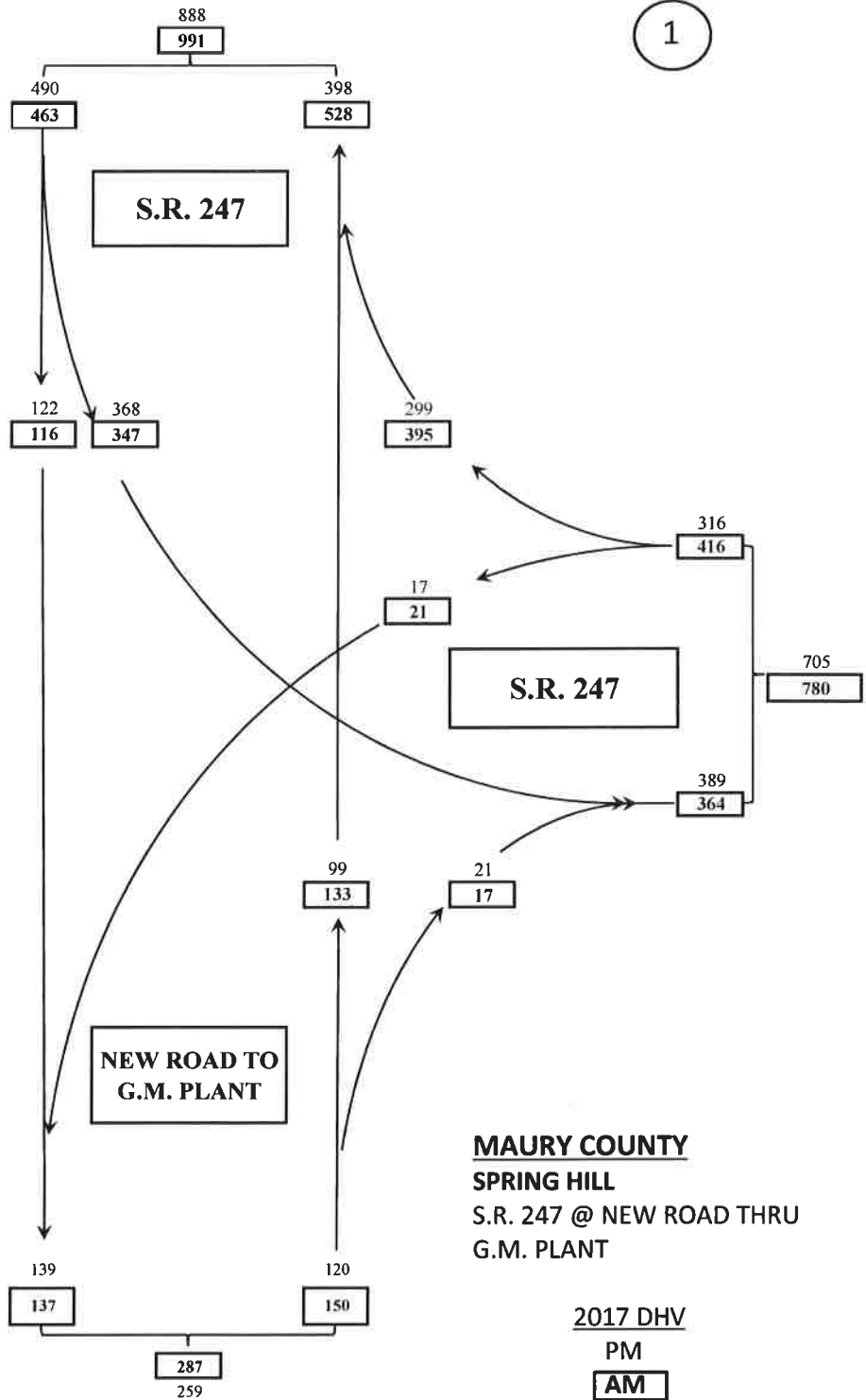

**MAURY COUNTY**  
**SPRING HILL**  
 S.R. 247 @ NEW ROAD THRU  
 G.M. PLANT

2017 DHV  
 PM  
**AM**

Date: Sept. 9, 2016

R.B.

2017 DHV

2

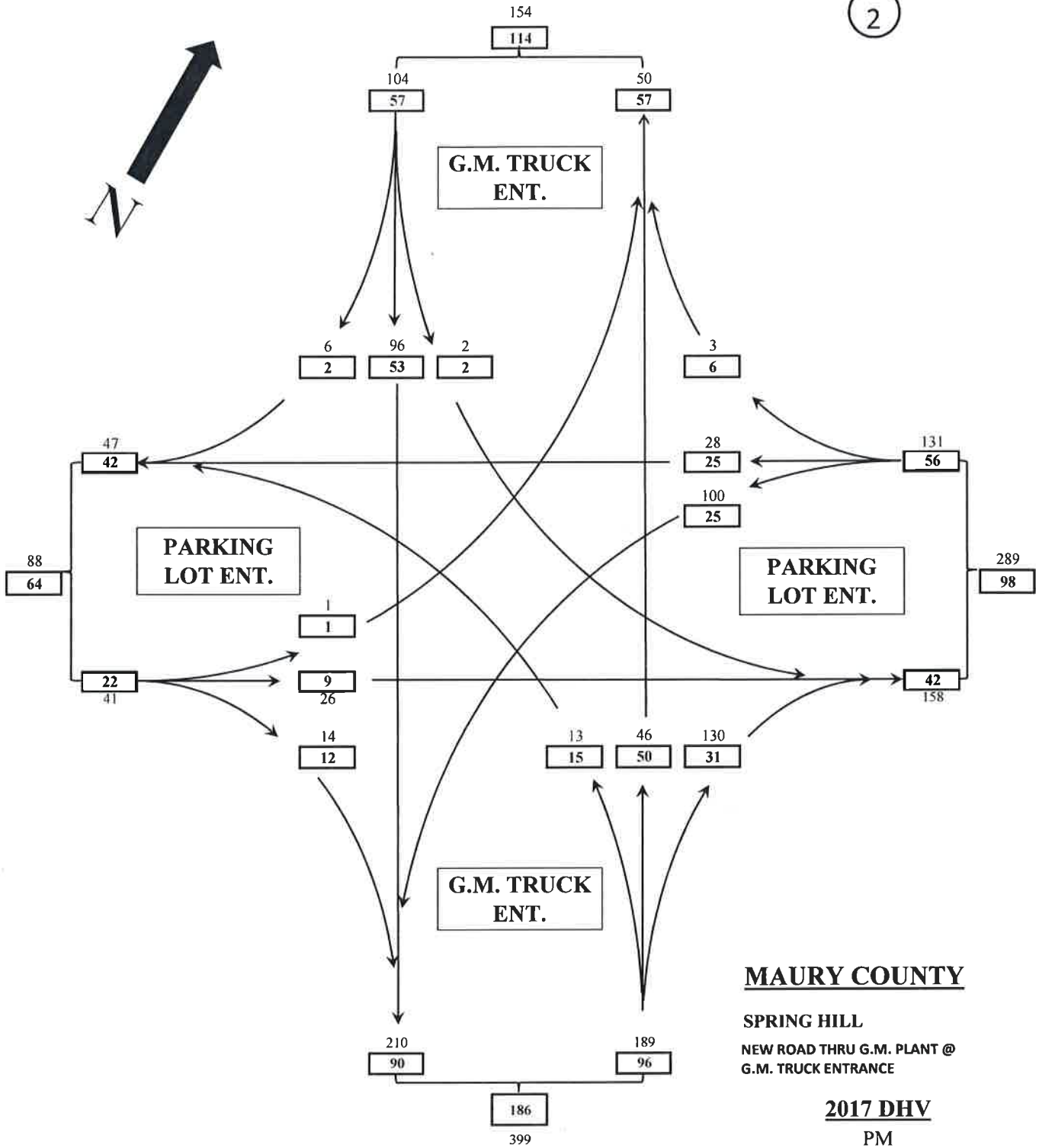

**MAURY COUNTY**

SPRING HILL  
NEW ROAD THRU G.M. PLANT @  
G.M. TRUCK ENTRANCE

2017 DHV  
PM  
AM





2037 DHV

1

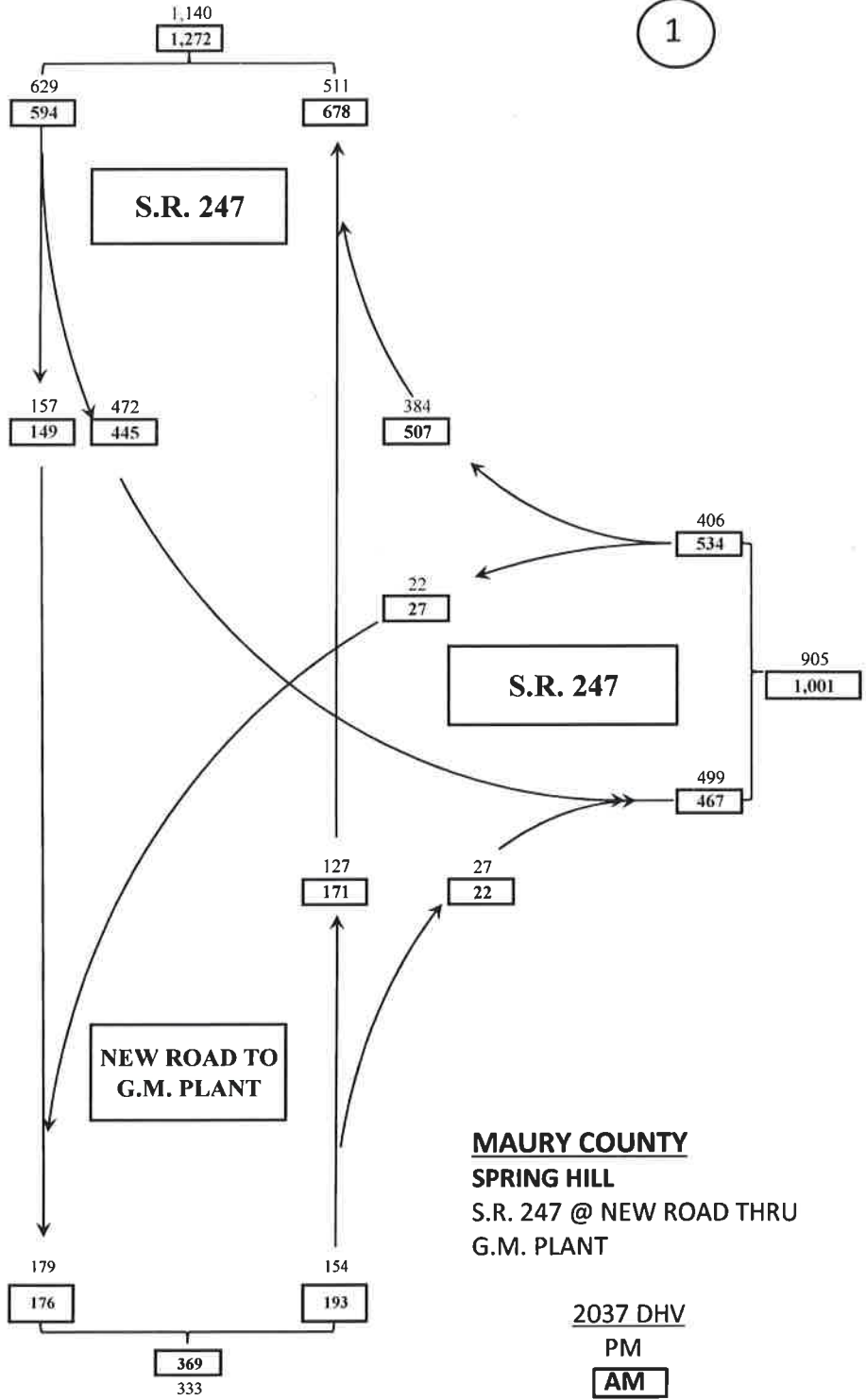

**MAURY COUNTY**  
**SPRING HILL**  
 S.R. 247 @ NEW ROAD THRU  
 G.M. PLANT

2037 DHV  
 PM  
 AM

Date: Sept. 9, 2016

R.B.

2037 DHV

2

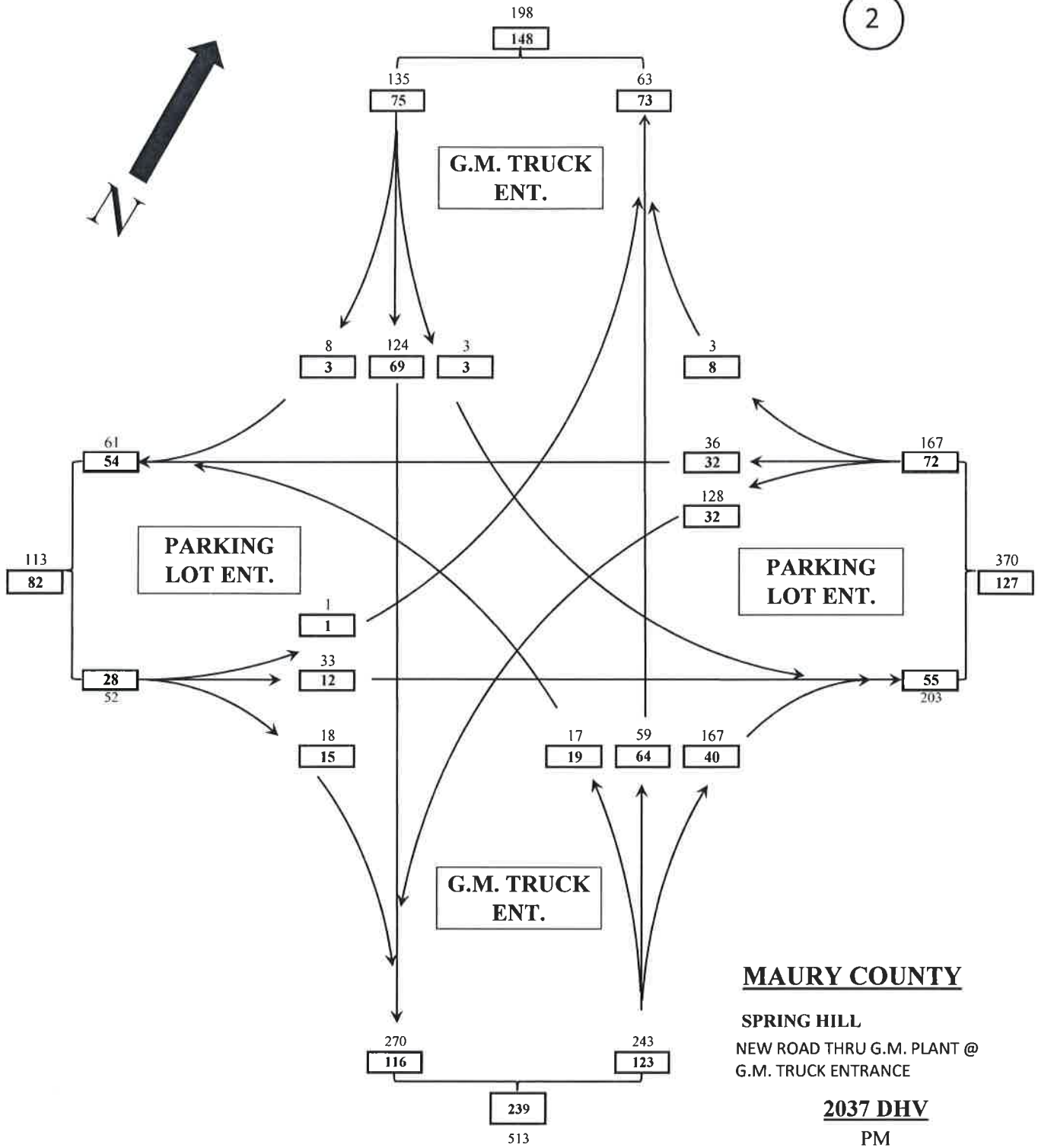

**MAURY COUNTY**

SPRING HILL  
NEW ROAD THRU G.M. PLANT @  
G.M. TRUCK ENTRANCE

2037 DHV  
PM  
AM