

# ELLINGTON

AGRICULTURAL CENTER

## TRAILS

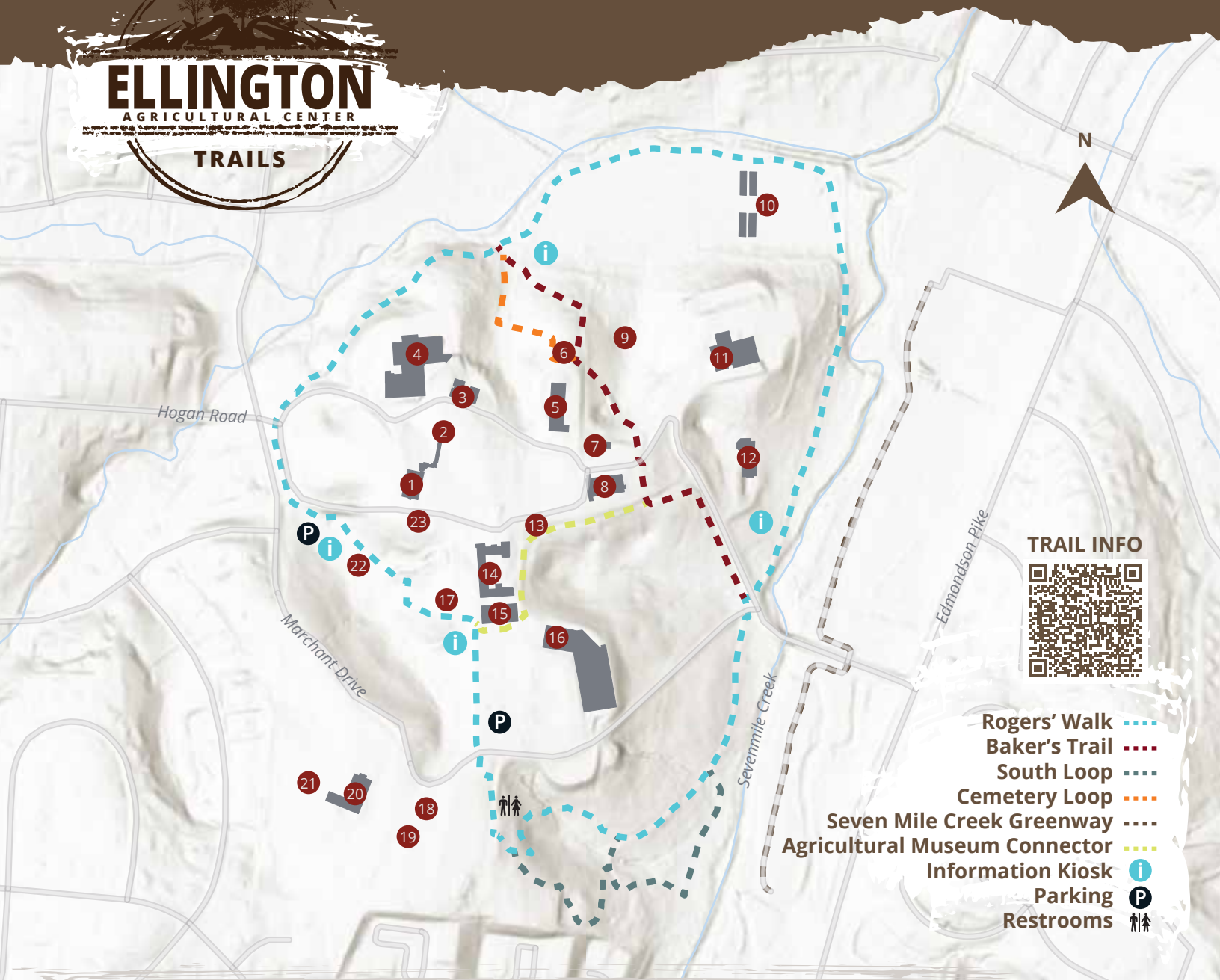

### TRAIL INFO



- Rogers' Walk ⋯
- Baker's Trail ⋯
- South Loop ⋯
- Cemetery Loop ⋯
- Seven Mile Creek Greenway ⋯
- Agricultural Museum Connector ⋯
- Information Kiosk i
- Parking P
- Restrooms ♿

- |  |  |
|--|--|
| 1 Moss Administration Building         | 13 Accounting Office                       |
| 2 Moss Building Annex                  | 14 Bruer Building                          |
| 3 Jennings Building                    | 15 Tennessee Agricultural Museum           |
| 4 Porter Building                      | 16 Exhibition Barn                         |
| 5 Holeman Building                     | 17 Log Cabins                              |
| 6 William Ewing Cemetery               | 18 Metrology Laboratory                    |
| 7 Commodity Distribution Building      | 19 Master Technician Termite Training Site |
| 8 Ed Jones Auditorium                  | 20 University of Tennessee Extension       |
| 9 The Gene Armstrong Apiary            | 21 Master Gardeners' Demonstration Site    |
| 10 Cul2vate                            | 22 Iris Garden and Gazebo                  |
| 11 Tennessee Wildlife Resources Agency | 23 Lou Wallace Library                     |
| 12 TWRA Region 2 Office                |  |